

Fix the left side and back plate with MSx12 self-tapping screws.

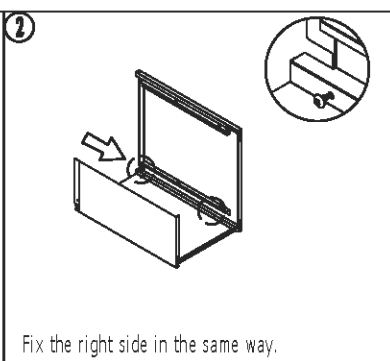

Fix the right side in the same way.

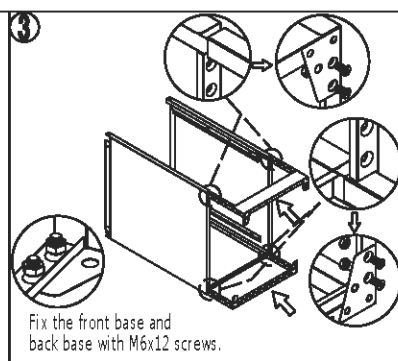

Fix the front base and back base with M6x12 screws.

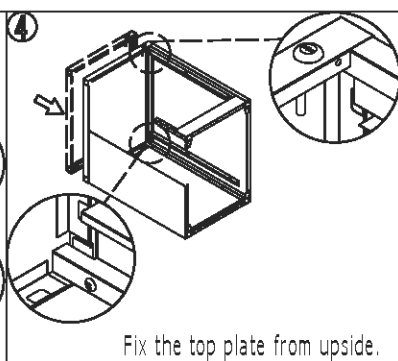

Fix the top plate from upside

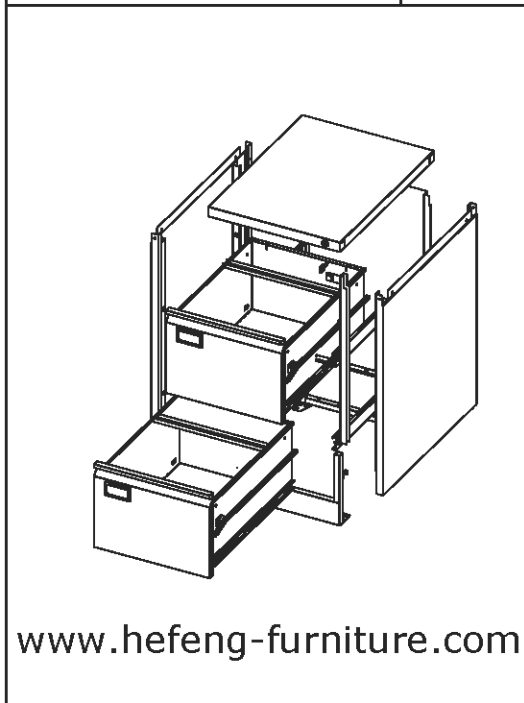

www.hefeng-furniture.com

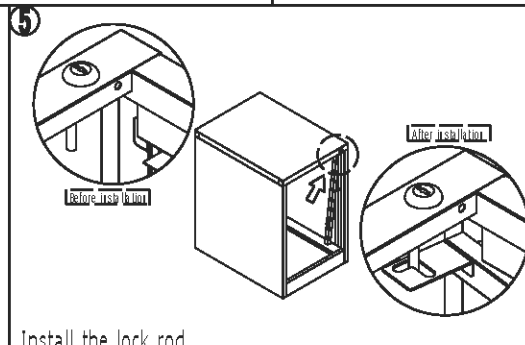

Install the lock rod.

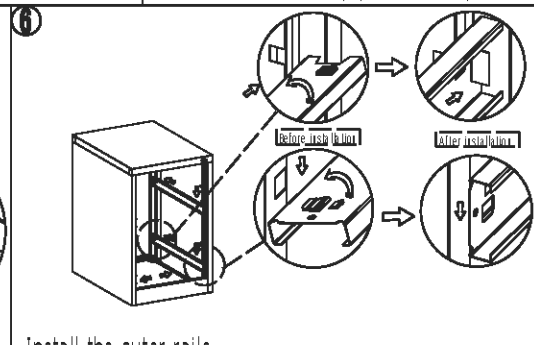

Install the outer rails.

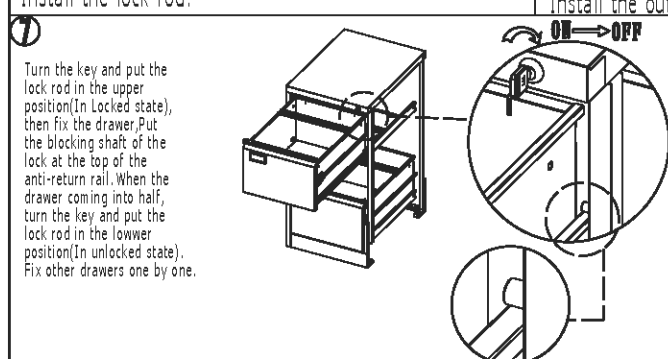

Turn the key and put the lock rod in the upper position (In Locked state), then fix the drawer. Put the blocking shaft of the lock at the top of the anti-return rail. When the drawer coming into half, turn the key and put the lock rod in the lower position (In unlocked state). Fix other drawers one by one.

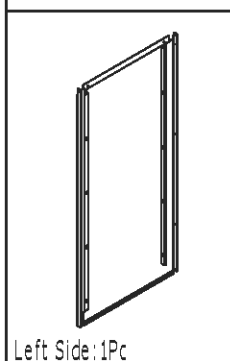
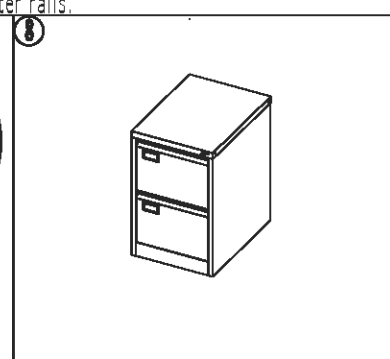

Left Side: 1Pc

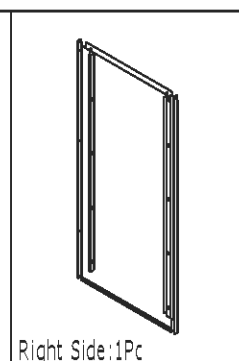

Right Side: 1Pc

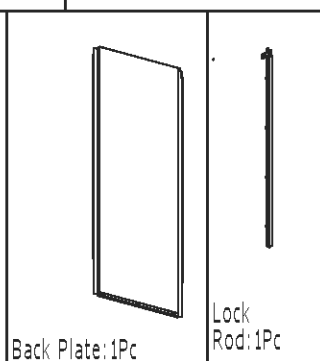

Back Plate: 1Pc

Lock Rod: 1Pc

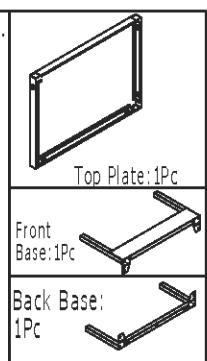

Top Plate: 1Pc

Front Base: 1Pc

Back Base: 1Pc

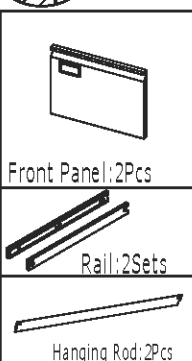

Front Panel: 2Pcs

Rail: 2Sets

Hanging Rod: 2Pcs

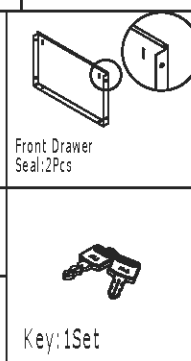

Front Drawer Seal: 2Pcs

Key: 1Set

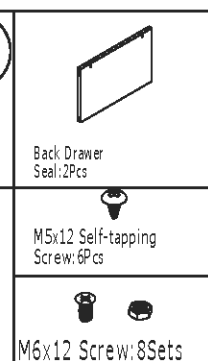

Back Drawer Seal: 2Pcs

M5x12 Self-tapping Screw: 6Pcs

M6x12 Screw: 8Sets

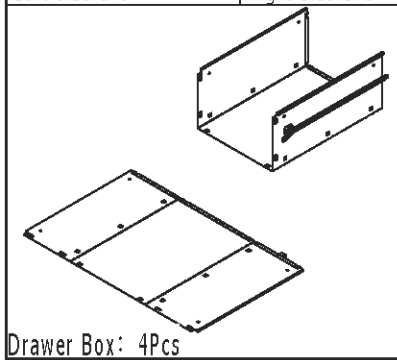

Drawer Box: 4Pcs

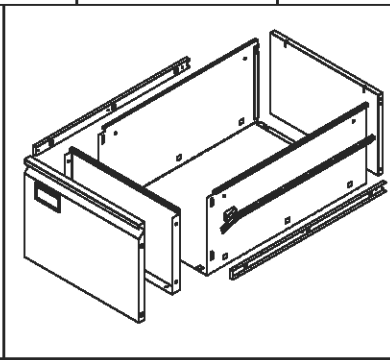

Push the back seal to the end.

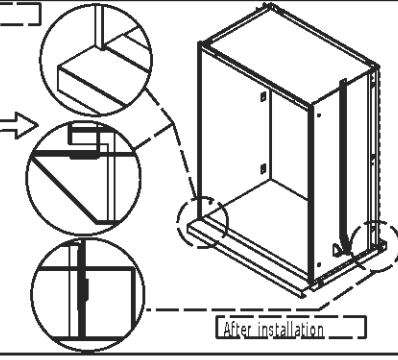

Install the front panel.

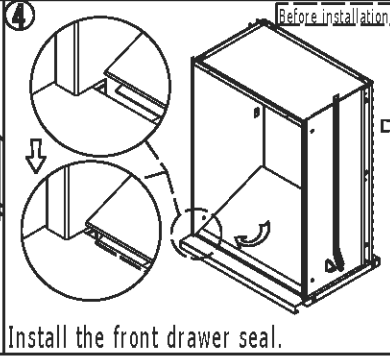

Install the front drawer seal.

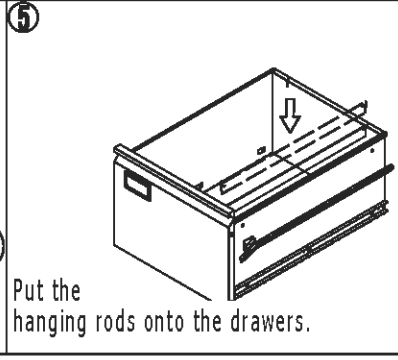

Put the hanging rods onto the drawers.